

B10 Series Fiber to HDMI Extender

BINARY

SETUP

1

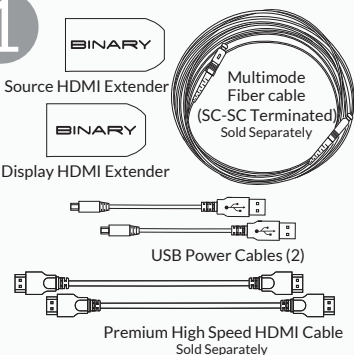

2

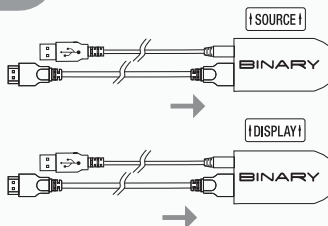

Insert USB power cable and up to 2 meter (6ft) B6 Premium High Speed HDMI Cable into each B10 Extender.

3

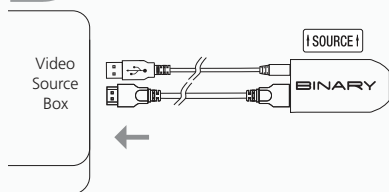

Connect the USB power and HDMI cables to the video source. Ensure the B10 extender labeled "source" is connected to the video source.

4

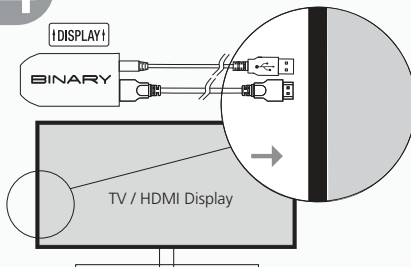

Connect the USB power and HDMI cables to the video source. Ensure the B10 extender labeled "Display" is connected to the video display.

5

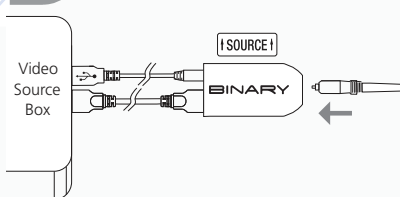

Insert one end of the multimode fiber cable with SC connector into the B10 extender labeled "source".

6

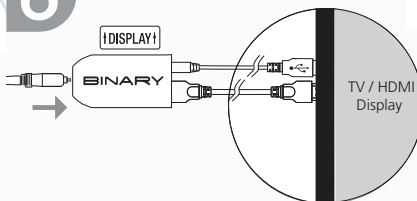

Insert one end of the multimode fiber cable with SC connector into the B10 extender labeled "display".
Power Up the system.

LED STATUS

OFF	Extender end has no power
RED	Extender detects an open fiber connection and has disabled the lasers
YELLOW	Fiber detected but link initialization failed
WHITE	Link functional with no HDCP video
GREEN	Link functional; with HDCP 1.x video
BLUE	Link functional with HDCP 2.x video
PURPLE	Fiber connection is open and lasers have been disabled. Bootloader connected for firmware upgrade.

Contacting Technical Support

Phone: (866) 838-5052

(704) 909-5229

Email: TechSupport@SnapAV.com

BINARY[®]

Rev: 190710-0825