

Halo Remote Touch Button Guide

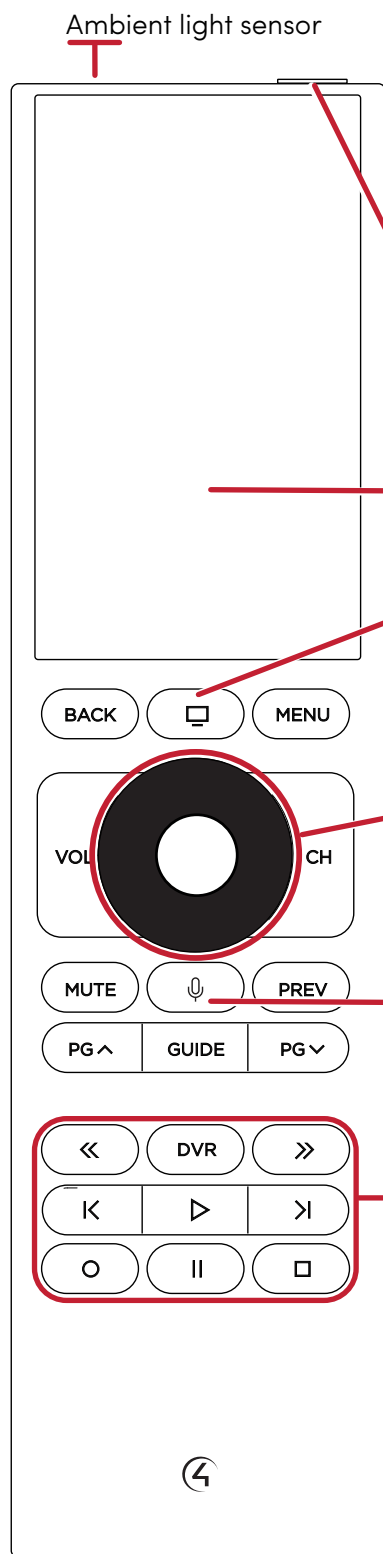

Welcome to your new remote

This guide outlines buttons specific to the Halo remote. Next to the power button is an ambient light sensor, to automatically adjust the screen and button brightness.

Quick press to turn a room off or press and hold to power the remote on or off.

Tap the touchscreen to select Favorites and menus. Swipe left to move from Favorites to Experience menus.

View the Control4 on-screen TV interface (if enabled).

Navigates and selects menu items of the current media device.

Push-to-talk voice control.

Playback controls.

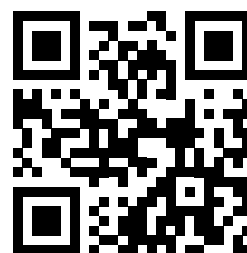

For more information on using your remote, visit ctrl4.co/halo-ig or scan this QR code